

PORT MELBOURNE 140 Nott Street

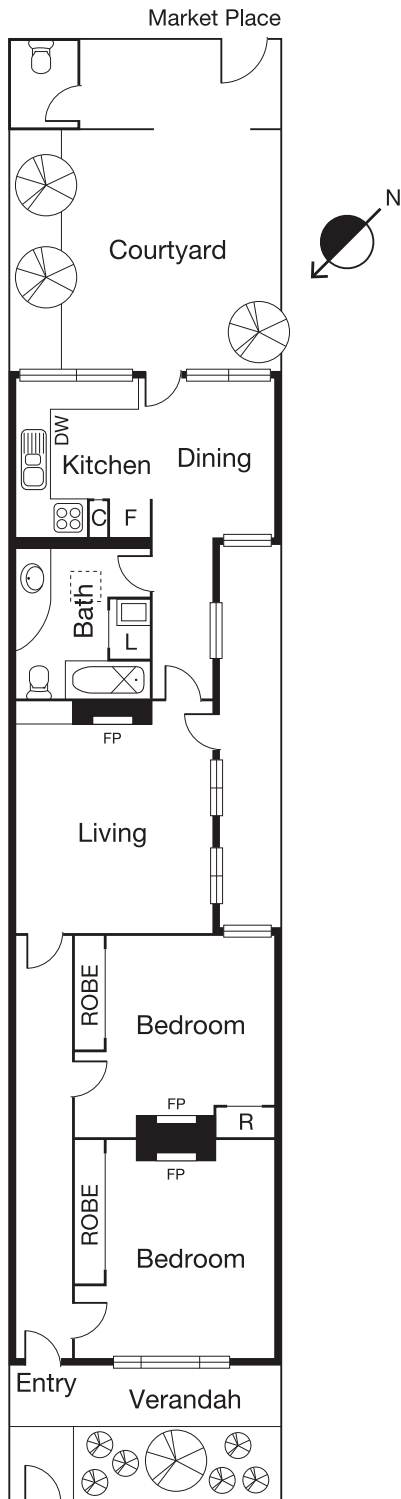

CAYZER



QUEENS TERRACE

- Wonderful brick Victorian terrace in superb location
- Polished floors throughout
- Only moments from Bay Street and the beach

Comprises: two double bedrooms, each with open fireplace and built in robes, light-filled central living room, central bathroom (incorporating laundry) and lovely kitchen with adjoining dining.

Low maintenance courtyard with a second external WC, undercover storage and rear laneway access. Ducted heating/cooling, high ceilings, internal lightwell. A charming home with terrific potential to value add. Allotment: 143sqm approx

2 1

Auction Saturday 8th December at 2.30pm

Inspection As advertised or by appointment

Contact Michael Szulc 0417 122 809
Jason De Stefano 0413 292 666
Jordan Gravestein 0448 250 193

Mel Ref 57 C2



Interactive Floorplan

CAYZER

Albert Park 330 Montague Street 03 9699 5999
Port Melbourne 370 Bay Street 03 9646 0812

cayzer.com.au